

620 TERMINAL WAY • P. O. BOX 938 • COSTA MESA, CALIFORNIA 92627 • (714) 642-1163

IMPORTANT: AN "N" SERIES QUICK SPOOL WILL NOT FIT THIS REEL.

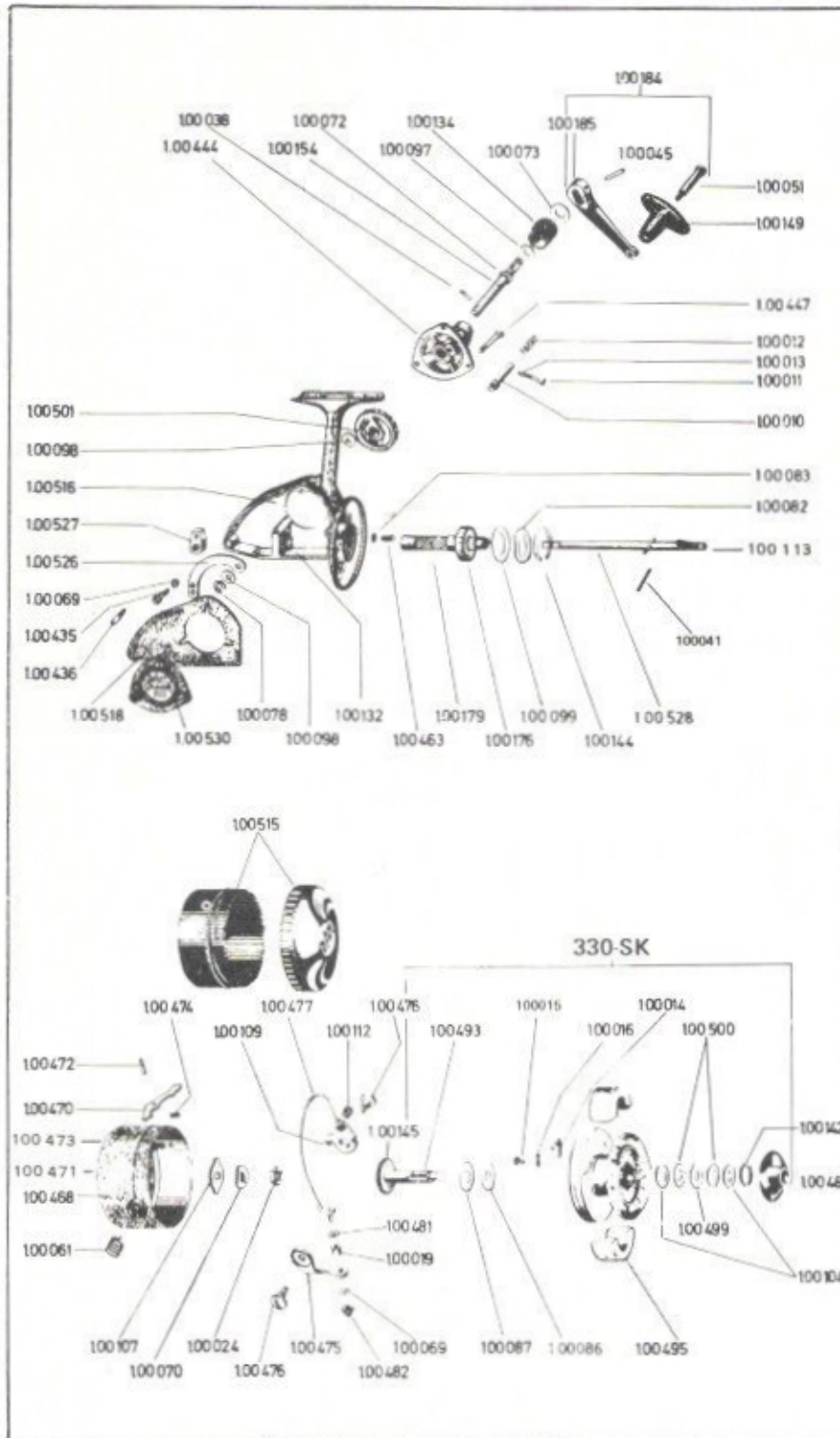

PART NO.	DESCRIPTION	PRICE LIST
100-010	Anti-reverse pin	.55
100-011	Ball Lever	.45
100-012	Spring	.25
100-013	Plastic tubing	.25
100-014	Click tongue	.30
100-015	Pin	.25
100-016	Spring	.30
100-019	Line guide	.30
100-024	Hexagon nut	.30
100-038	Pin for drive gear	.30
100-041	Pin for axle	.30
100-045	Pin for crank arm	.30
100-051	Grip screw	.40
100-061	Ball spring	.40
100-069	Lock washer	.30
100-070	Spring washer	.25
100-072	Safety clip	.25
100-073	Washer	.25
100-078	Safety clip	.25
100-082	Spring washer	.25
100-083	Washer	.25
100-086	Washer (metal)	.15
100-087	Washer (resitex)	.25
100-097	Washer	.25
100-098	Washer	.25
100-099	Packing ring	.25
100-104	Washer (metal)	.30
100-107	Driving plate	.30
100-109	Rubber buffer	.25
100-112	Cover cap	.30
100-113	Axle spool catch	.25
100-132	Bearing bushing for housing	.40
100-134	Crank nut	.70
100-142	Snap ring	.25
100-144	Snap ring	.25
100-145	Ratchet wheel	.35
100-149	Handle grip	.40
100-154	Drive axle	1.45
100-176	Ball bearing	3.00
100-179	Drive shaft	2.50
100-184	Crank arm complete	1.90
100-185	Crank arm	1.30
100-435	Screw for slide	.15
100-436	Screw for axle	.25
100-444	Bearing cover	1.90
100-447	Screw for bearing cover	.25
100-463	Ball trip screw	.30
100-468	Rotating head	5.35
100-470	Trip lever	.65
100-471	Trip lever holder	.45

100-472	Bearing pin	.25
100-473	Rivet for P/N 100-471	.25
100-474	Spring for stop lever	.25
100-475	Angle lever	.85
100-476	Bearing screw	.45
100-477	Ball	2.95
100-481	Washer	.25
100-482	Hexagon nut	.30
100-488	Drop nut	1.45
100-493	Brake spindle w/o ratchet wheel	1.50
100-495	Cork ring halves (2)	.40
100-499	Drive plate	.25
100-500	Washer	.25
100-501	Drive gear	2.05
100-515	Plastic box for line spool	.75
100-516	Housing	5.35
100-518	Housing cover	.65
100-526	Slide	.55
100-527	Connecting piece	.45
100-528	Axle, complete	1.85
100-530	Side plate cover	1.45

ADDITIONAL SPARES FOR HIGH SPEED REEL NO. 331		
S100-206	Drive Shaft	2.50
S100-208	Crank Assembly complete	2.20
S100-209	Crank arm	1.65
S100-521	Side plate cover	1.45
S100-522	Drive gear	2.05
330SK	Spool, complete	8.90